



Technical Data

Euro Module RCA Outlets

Brief product description:

Quick and easy to install, the Euro Module range provides flexibility for the end user to create a configuration that is customised for their need.

Features:

- Euro Module design, clips in to front plates
- RCA/Phono x 2 outlets
- Used to carry audio and video signals
- Screw terminals

Product Images



EMRCA2B



EMRCA2BG



EMRCA2BW



Line Diagrams

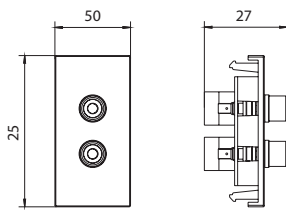

EMRCA2x

Technical Specifications

Standards	BS 5733
Connection	2 x RCA/Phono
Module Dimensions	25mm x 50mm
RoHS Directive	No
WEEE Directive	No
Mounting Box Depth (Min)	25mm



Packaging Information

Cat No.	Description	Packaging Type			Pack Quantity			Barcode		
		Product	Inner Box	Outer Box	Each	Inner Box	Outer Box	Individual	Inner Box	Outer Box
EMRCA2B	RCA MOD - BLACK	Printed bag	Printed Box	Printed Box	1	10	100	5050765048088	5050765048118	5050765048149
EMRCA2G	RCA MOD - GREY	Printed bag	Printed Box	Printed Box	1	10	100	5050765048095	5050765048125	5050765048156
EMRCA2W	RCA MOD - WHITE	Printed bag	Printed Box	Printed Box	1	10	100	5050765048071	5050765048101	5050765048132

Weights & Dimensions

Cat No.	Description	Dimensions (H x W x D) cm				Weight (kg)				CBM (m ³)
		Unpacked Product	Packed Product	Inner Box	Outer Box	Each	Packed Product	Inner Box	Outer Box	Outer Box
EMRCA2*	RCA MODULE	5.0 x 2.5 x 2.7	11.0 x 7.0 x 2.9	6.2 x 7.7 x 14.7	16.5 x 16.0 x 32.0	0.016	0.017	0.20	2.16	0.00845

British General Helpline
03300 249 279

Supplied by
Luceco PLC
Stafford Park 1 Telford TF3 3BD ENGLAND

Visit our website at
www.bgelectrical.uk