



Technical Data

Euro Module Telecom & Data Outlets

Brief product description:

Quick and easy to install, the Euro Module range provides flexibility for the end user to create a configuration that is customised for their need.

Features:

- Euro Module design, clips in to front plates
- Master and Secondary telecom outlets, screw and IDC terminals
- Data outlets for either Cat5e or Cat6 connections

Product Images



EMBTMIB EMBTMIG EMBTMIW EMBTMSB EMBTMSG EMBTMSW



EMBTSIB EMBTSIG EMBTSIW EMBTSSB EMBTSSG EMBTSSW

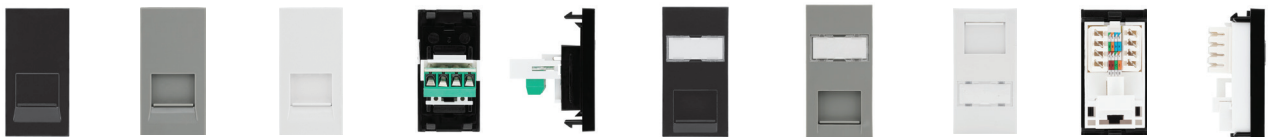

EMRJ11B EMRJ11G EMRJ11W EMRJ45C5EB EMRJ45C5EG EMRJ45C5EW



EMRJ45C6B EMRJ45C6G EMRJ45C6W

Line Diagrams

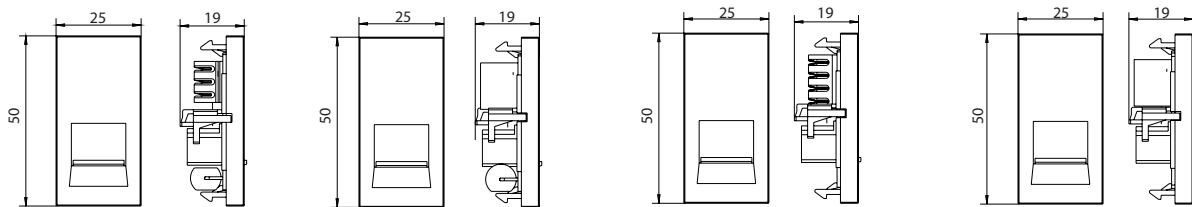

EMBTMIx EMBTMSx EMBTSx EMBTSSx

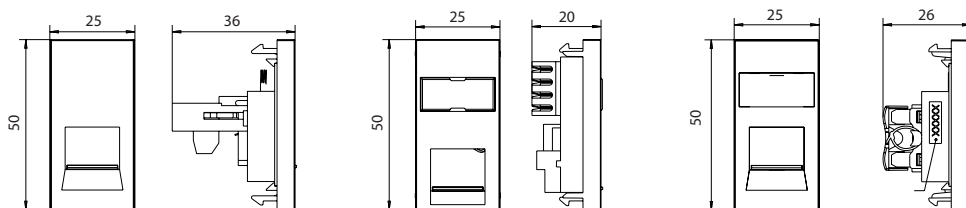

EMRJ11x EMRJ45C5Ex EMRJ45C6x



Euro Module Telecom & Data Outlets

Technical Specifications

Standards	BS 6312-2
Connection	Screw terminals (EMBTMSx, EMBTSSx, EMRJ11x products)
	IDC terminals (EMBTMIx, EMBTSIx, EMRJ45C5Ex, EMRJ45C6x products)
Module Dimensions	25mm x 50mm
RoHS Directive	No
WEEE Directive	No
Mounting Box Depth (Min)	25mm



Packaging Information

Cat No.	Description	Packaging Type			Pack Quantity			Barcode		
		Product	Inner Box	Outer Box	Each	Inner Box	Outer Box	Individual	Inner Box	Outer Box
EMBTMIB	BT MASTER (IDC) - BLACK	Printed Bag	Printed Carton	Printed Carton	1	10	100	5050765026321	5050765026635	5050765026840
EMBTMIG	BT MASTER (IDC) - GREY	Printed Bag	Printed Carton	Printed Carton	1	10	100	5050765026338	5050765026642	5050765026857
EMBTMIW	BT MASTER (IDC) - WHITE	Printed Bag	Printed Carton	Printed Carton	1	10	100	5050765026314	5050765026628	5050765026833
EMBTMSB	BT MASTER (SCREW) - BLACK	Printed Bag	Printed Carton	Printed Carton	1	10	100	5050765026291	5050765026604	5050765026819
EMBTMSG	BT MASTER (SCREW) - GREY	Printed Bag	Printed Carton	Printed Carton	1	10	100	5050765026307	5050765026611	5050765026826
EMBTMSW	BT MASTER (SCREW) - WHITE	Printed Bag	Printed Carton	Printed Carton	1	10	100	5050765026284	5050765026598	5050765026802
EMBTSIB	BT SECONDARY (IDC) - BLACK	Printed Bag	Printed Carton	Printed Carton	1	10	100	5050765026383	5050765026697	5050765026901
EMBTSIG	BT SECONDARY (IDC) - GREY	Printed Bag	Printed Carton	Printed Carton	1	10	100	5050765026390	5050765026703	5050765026918
EMBTSIW	BT SECONDARY (IDC) - WHITE	Printed Bag	Printed Carton	Printed Carton	1	10	100	5050765026376	5050765026680	5050765026895
EMBTSSB	BT SECONDARY (SCREW) - BLK	Printed Bag	Printed Carton	Printed Carton	1	10	100	5050765026352	5050765026666	5050765026871
EMBTSSG	BT SECONDARY (SCREW) - G	Printed Bag	Printed Carton	Printed Carton	1	10	100	5050765026369	5050765026673	5050765026888
EMBTSSW	BT SECONDARY (SCREW) - WH	Printed Bag	Printed Carton	Printed Carton	1	10	100	5050765026345	5050765026659	5050765026864
EMRJ11B	RJ11 (SCREW) - BLACK	Printed Bag	Printed Carton	Printed Carton	1	10	100	5050765026512	5050765026727	5050765026932
EMRJ11G	RJ11 (SCREW) - GREY	Printed Bag	Printed Carton	Printed Carton	1	10	100	5050765026529	5050765026734	5050765026949
EMRJ11W	RJ11 (SCREW) - WHITE	Printed Bag	Printed Carton	Printed Carton	1	10	100	5050765026406	5050765026710	5050765026925
EMRJ45C5EB	RJ45 CAT5E (IDC) - BLACK	Printed Bag	Printed Carton	Printed Carton	1	10	100	5050765026550	5050765026765	5050765026970
EMRJ45C5EG	RJ45 CAT5E (IDC) - GREY	Printed Bag	Printed Carton	Printed Carton	1	10	100	5050765026543	5050765026758	5050765026963
EMRJ45C5EW	RJ45 CAT5E (IDC) - WHITE	Printed Bag	Printed Carton	Printed Carton	1	10	100	5050765026536	5050765026741	5050765026956
EMRJ45C6B	RJ45 CAT6 (IDC) - BLACK	Printed Bag	Printed Carton	Printed Carton	1	10	100	5050765026581	5050765026796	5050765027007
EMRJ45C6G	RJ45 CAT6 (IDC) - GREY	Printed Bag	Printed Carton	Printed Carton	1	10	100	5050765026574	5050765026789	5050765026994
EMRJ45C6W	RJ45 CAT6 (IDC) - WHITE	Printed Bag	Printed Carton	Printed Carton	1	10	100	5050765026567	5050765026772	5050765026987

Weights & Dimensions

Cat No.	Description	Dimensions (H x W x D) cm				Weight (kg)				CBM (m ³)
		Unpacked Product	Packed Product	Inner Box	Outer Box	Each	Packed Product	Inner Box	Outer Box	Outer Box
EMBTMI*	BT MASTER (IDC)	5.0 x 2.5 x 1.9	11.0 x 7.0 x 2.1	6.2 x 7.7 x 14.7	16.5 x 16.0 x 32.0	0.014	0.019	0.26	2.60	0.00845
EMBTMS*	BT MASTER (SCREW)	5.0 x 2.5 x 1.9	11.0 x 7.0 x 2.1	6.2 x 7.7 x 14.7	16.5 x 16.0 x 32.0	0.014	0.015	0.18	1.96	0.00845
EMBTSI*	BT SECONDARY (IDC)	5.0 x 2.5 x 1.9	11.0 x 7.0 x 2.1	6.2 x 7.7 x 14.7	16.5 x 16.0 x 32.0	0.013	0.014	0.17	1.86	0.00845
EMBTSS*	BT SECONDARY (SCREW)	5.0 x 2.5 x 1.9	11.0 x 7.0 x 2.1	6.2 x 7.7 x 14.7	16.5 x 16.0 x 32.0	0.014	0.015	0.17	1.88	0.00845
EMRJ11*	RJ11 (SCREW)	5.0 x 2.5 x 3.6	11.0 x 7.0 x 3.8	6.2 x 9.0 x 14.7	17.5 x 20.0 x 32.5	0.265	0.015	0.23	2.40	0.01138
EMRJ45C5E*	RJ45 CAT5E (IDC)	5.0 x 2.5 x 2.0	11.0 x 7.0 x 2.2	6.2 x 7.7 x 14.7	16.5 x 16.0 x 32.0	0.012	0.014	0.17	1.88	0.00845
EMRJ45C6*	RJ45 CAT6 (IDC)	5.0 x 2.5 x 2.6	11.0 x 7.0 x 2.7	6.2 x 7.7 x 14.7	16.5 x 16.0 x 32.0	0.011	0.012	0.15	1.68	0.00845