



Read these instructions before commencing installation. Please give these instructions to the owner/occupier after installation to retain for future reference/maintenance.

IP20

Compatible fittings :- KSRFRD385 (Inc Anti-Glare version)
KSRFRD386 & KSRFRD387

Important Information

KSR will not accept responsibility for any claims arising from a poor installation. Please Note: The limited warranty shall be deemed null and void in the following circumstances: Failure by the installer, end user or any third party to exercise caution to protect any covered product or part from outside damage, adverse temperature, humidity conditions or physical abuse as well as failure related to workmanship in the installation of the products or parts.

Important User Advice

These Retro-Fit rings are suitable for indoor use only and should not be fitted to damp or wet surfaces such as freshly plastered or painted ceilings.

Please note that even though this is used with a Fire & IP Rated product it will not continue to be Fire Rated & only IP20 Rated.

Installation Procedure

KSR recommends that you familiarise yourself with the installation. Once you are completely satisfied: Switch off mains supply. This Retro fit ring is suitable to install the KSR Qr Range of downlights (KSRFRD385, KSRFRD386 & KSRFRD387) in installations where an existing cut-out of 90-150mm is present. Ensure sufficient ceiling void for the fitting used without infringing on joists, water pipes or electrical cables.

Remove the existing white rim supplied with the downlight, push the spring clips all the way up and hold whilst you install the locator ring onto the back of the fitting, slide this all the way down to the back of inner black rim as shown (Fig.1), **being careful** not to allow the springs to snap back onto your fingers / hands. Then place the fitting with the locator ring onto the back of the White Ring supplied and line up the grooves with the tabs on the White Ring and twist clockwise into place ensuring all 4 are located securely.

This is now ready to install into the ceiling, fit as you would a normal downlight and please refer to the installation sheet of the downlight you have chosen of how to fit and wire correctly.

For the larger retro fit rings (KSRFRD378 & 379) you will need to use the longer clip covers provided to go over the existing spring clips already present on the fittings, please ensure the flat side of the clips are facing down locating on the back of the ceiling or whatever it is fitted into.

Available Finishes: White Only.

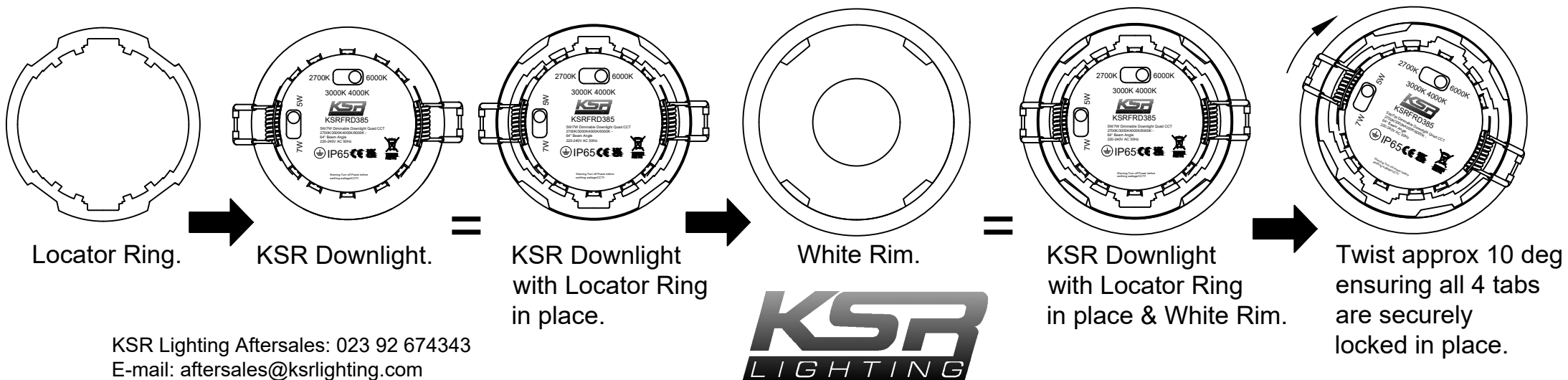
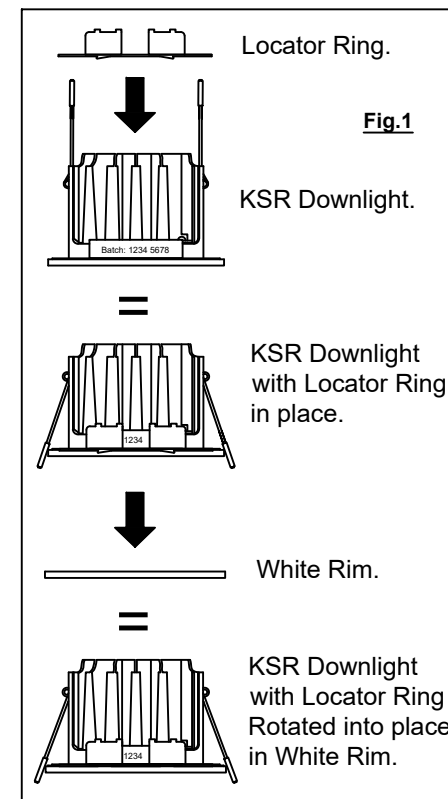



Available Finishes: White Only.

Read these instructions before commencing installation. Please give these instructions to the owner/occupier after installation to retain for future reference/maintenance.

IP20

**Compatible fittings :- KSRFRD385 (Inc Anti-Glare version)
KSRFRD386 & KSRFRD387**

	ØRim Size	ØCut out	Void Depth Req'd	Colour
KSRFRD377	100mm	90mm	See fitting used info	White
KSRFRD378	135mm	100mm - 120mm	See fitting used info	White
KSRFRD379	170mm	110mm - 150mm	See fitting used info	White

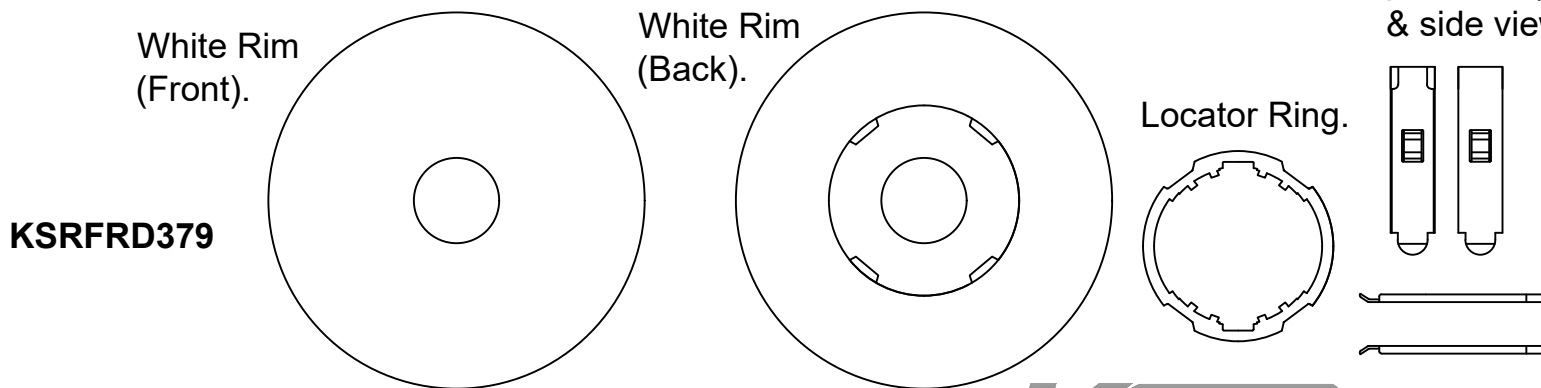
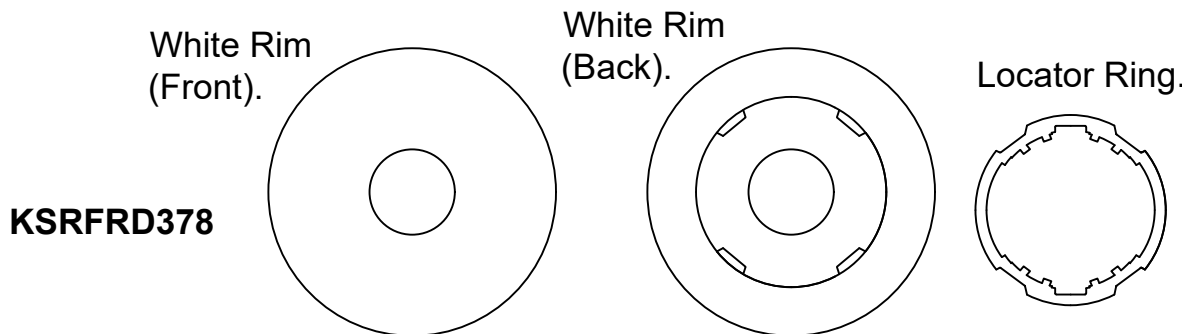
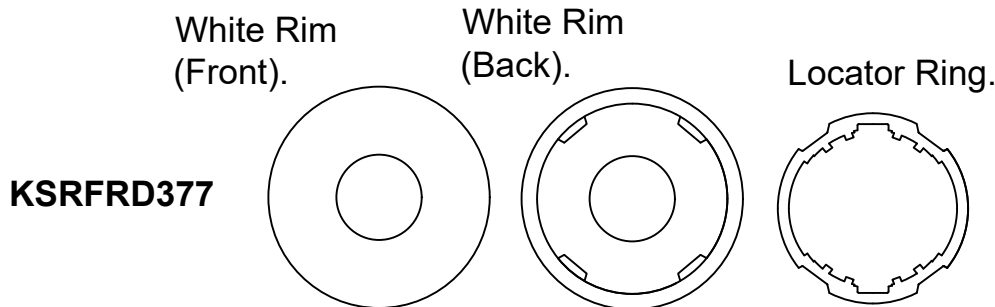

2 Spring clip covers provided (front, rear & side views shown).

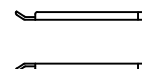
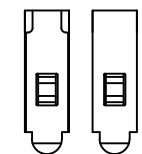

2 Spring clip covers provided (front, rear & side views shown).

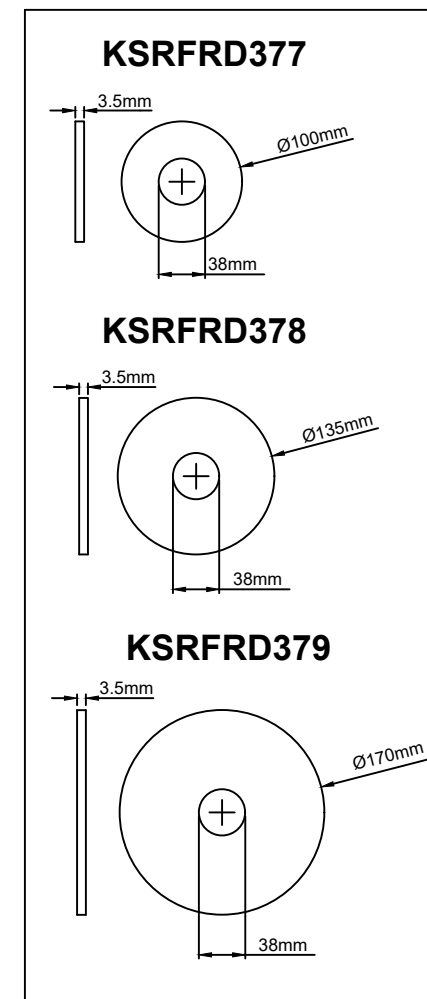
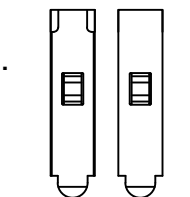

KSR Lighting Aftersales: 023 92 674343
E-mail: aftersales@ksrlighting.com

