

## T90xr

### electric shower

The T90xr Pumped is a tank fed integral pumped electric shower designed for installations where the mains water supply pressure is too low, unreliable or non-existent. It can therefore be used in locations unsuitable for normal electric showers. This remarkable problem solving shower is fed from your cold water tank which can be as little as 8 cm above the unit.

### style and finish options

T90xr electric shower available with showerhead and riser rail  
White/Chrome

- **Pumped electric shower** for installation where the mains water pressure is too low, unreliable or non-existent
- **Push START/STOP button**
- **Power selector** for selection of Cold, Economy and High
- **Temperature control** with a numbered dial for easy temperature selection
- **'Power On' indicator**
- **Rub-clean showerhead**  
5 spray patterns
- **Power rating**  
8.5kW or 9.5kW
- **Power rating**  

240V	230V	MCB protection device
8.5kW	7.9kW	40 Amps
8.5kW	7.9kW	40 Amps



**T90xr**  
**electric shower**  
8.5kW – SP9008XR  
9.5kW – SP9009XR

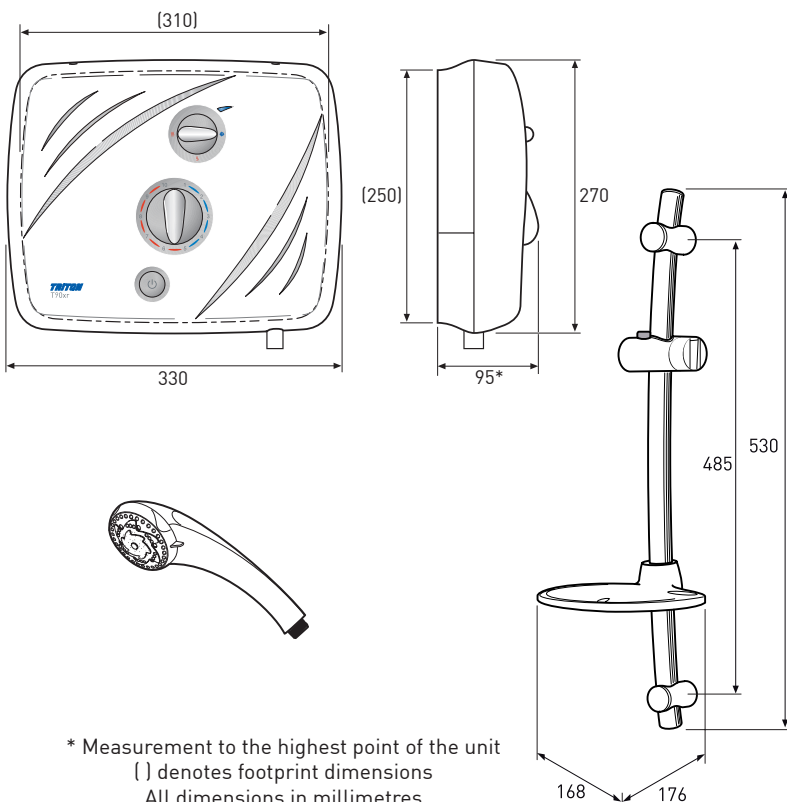

### Temperature / flow rate

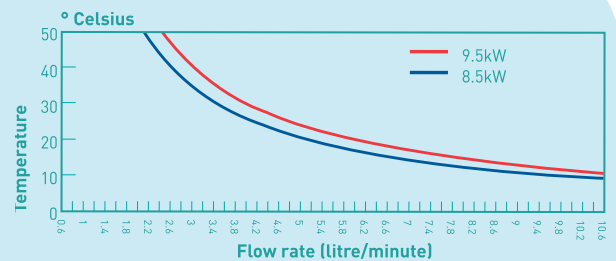

**Note:** The approximate temperatures indicated are based on 0°C ambient incoming water temperature. This can vary between 3°C and 23°C, depending on weather conditions.

### Entry points

	Top	Bottom	Back	Left	Right
Electric	✓	✓	✓	✗	✗
Water	✓	✓	✓	✗	✗

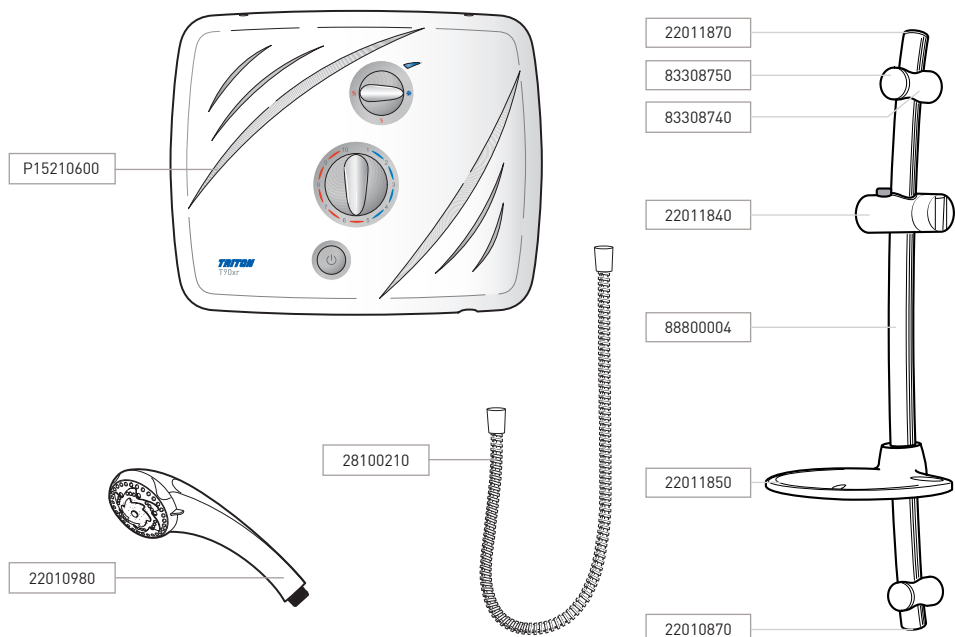
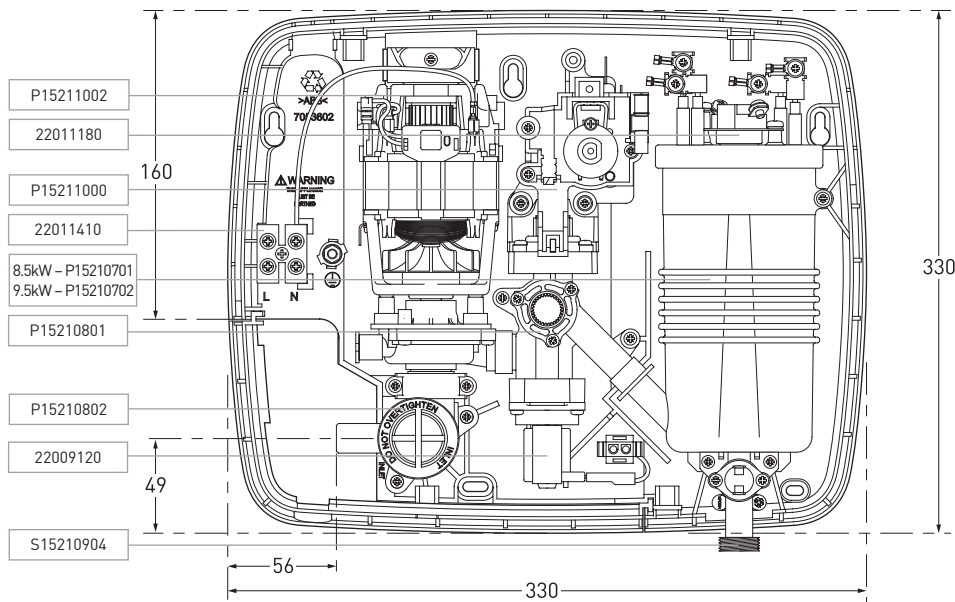

PART NUMBER	DESCRIPTION	PART NUMBER	DESCRIPTION
P15211002	Pump & motor assembly	P15210600	Cover assembly
22011410	Terminal block	7053603	Trimplate
22011180	Thermal cut-out (TCO)	7053604	Pipe trim
<b>CAN ASSEMBLY:</b>			
P15210701	8.5kW	<b>RISER RAIL</b>	
P15210702	9.5kW	83308740	Brackets & trims (pair)
P15211000	Selector switch, microswitch & wire assembly	83308750	Trim (single)
P15210801	Flow valve assembly & solenoid	88800004	Riser rail
P1520802	Filter assembly	22011870	Riser rail end trims (pair)
22009120	Solenoid	22011840	Showerhead holder
S15210904	Outlet pipe & terminal block wiring assembly	22011850	Soap dish
82300510	Start/Stop switch	28100210	Flexible hose
82800450	Pressure relief device (PRD)	<b>SHOWERHEAD</b>	
		22010980	Showerhead

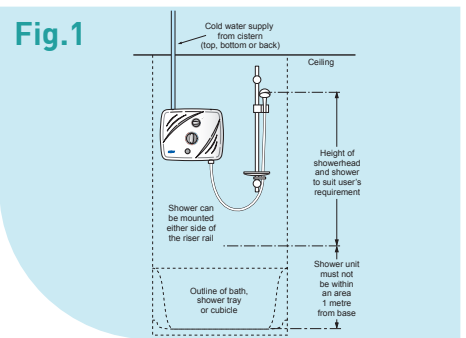

### SITING OF THE SHOWER

**IMPORTANT:** If installing onto a tiled wall always mount the unit on the surface of the tiles. NEVER tile up to the unit. Refer to Fig.1 for correct siting of shower. Position the unit where it will NOT be in direct contact with water from the showerhead. Position the shower unit vertically. Leave enough room between the ceiling and the shower to allow access to the cover top screws.

**Note:** Water Regulations require the showerhead be 'constrained by a fixed or sliding attachment so that it can only discharge water at a point not less than 25 mm above the spill-over level of the relevant bath, shower tray or other fixed appliance'. The use of the supplied retaining ring/soap dish will in most cases meet this requirement, but if the showerhead can be placed within a bath, basin or shower tray, then a double check valve, or similar, must be fitted in the supply pipework to prevent back-flow.

**Pressure relief safety device:** A pressure relief device (PRD) is designed into the shower unit which complies with European standards. The PRD provides a level of appliance protection should an excessive build up of pressure occur within the shower. DO NOT operate the shower with a damaged or kinked shower hose, or a blocked showerhead which can cause the PRD to operate. When commissioning, the showerhead must be removed from the flexible hose, while at the same time the temperature control must be at the minimum flow position. Failure to follow this procedure may also cause the PRD to operate. Make sure the shower is positioned over a bath or shower tray because if the PRD operates, then water will eject from the bottom of the unit. Should this happen, turn off the electricity and water supplies to the shower at the isolating switch and stopvalve. Contact Customer Service for advice on replacing the PRD. The PRD is situated behind the outlet pipe. To access the PRD, FIRST SWITCH OFF THE ELECTRICITY SUPPLY, unscrew the hose then remove the cover. Remove the two screws holding the outlet pipe to the base of the can. Carefully pull away from the can and then unscrew the two screws holding the PRD to the outlet pipe.

**CAUTION: Do not attempt to replace the PRD unless competent to do so.**

**Note:** Before replacing the cover, it is strongly advised to prime the unit.

**WARNING! The shower must not be positioned where it will be subjected to freezing conditions.**

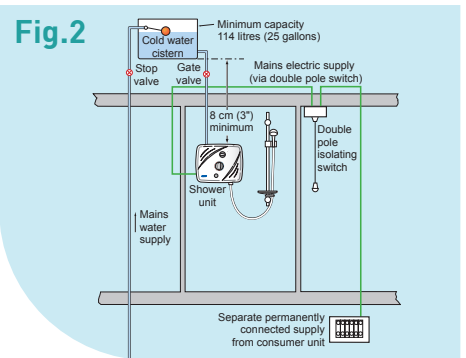

### WATER REQUIREMENTS

The installation must be in accordance with the Water Regulations/Bylaws. To ensure activation of the heating elements, the shower must be connected to a cold water supply which is gravity fed from a static cold water storage cistern with a minimum capacity of 114 litres (25 gallons). There must be a maximum head of water of 10 metres and a minimum head of 8 cm, as measured between the bottom of the cistern and the top of the shower unit. There must be no other cold water draw-offs between the cistern and the unit and the pipe must not supply water to any other tap or fitting at a lower level.

**Note:** The supply pipe from the cistern should be on the opposite side to the float operated valve to prevent air being drawn into the pipe when the cistern is filling. If it is intended to operate the shower in hard water areas (above 200 ppm temporary hardness) a scale inhibitor should be fitted. Fig.2 shows a typical system layout.

**DO NOT use jointing compounds on any pipe fittings for the installation.**

**WARNING! Under no circumstances must this T90xr shower be connected directly to the mains water supply.**

### APPROVALS

Products conform to EU New Approach Directives i.e. Low Voltage Directive and EMC Directive.



SHOWERS

A MORGHOS Company

To contact Triton's Technical Advice Team, please call

**+44 (0) 87 0067 3333**

Triton Plc, Shepperton Park, Triton Road, Nuneaton, Warwickshire CV11 4NR  
Tel: +44 (0) 87 0067 3333 Fax: +44 (0) 87 0067 3334 www.tritonshowers.co.uk

It is our policy to improve the design and specification of our products and we reserve the right to depart from the details given without prior notice.